

DH-IPC-HDW1230DT-STW

2 MP IR Fixed-focal WiFi Eyeball Network Camera



Series Overview

Driven by industry-leading technology, Dahua Wi-Fi series network cameras are highly precise and easy to install, producing high-quality images. They have strong Wi-Fi connection capabilities and do not require network cables, eliminating the need for a professional construction team. This series of cost-effective cameras support SD card storage, and are dustproof and waterproof. They are ideal for small and medium-sized scenes such as retail stores, homes, and other small and medium-sized enterprises.

Functions

Smart H.265+ & Smart H.264+

With advanced scene-adaptive rate control algorithm, Dahua smart encoding technology realizes the higher encoding efficiency than H.265 and H.264, provides high-quality video, and reduces the cost of storage and transmission.

Two-way Audio

With its built-in high-sensitivity microphone and high-power speaker, the camera realizes two-way audio through the mobile app.

Dual-antenna

High-performance dual antenna and MIMO (multiple-input and multiple output) technology of the network camera make the WiFi transmission distance farther, anti-interference performance better, and video transmission smoother.

Motion Detection

When moving objects appear in the monitoring image, Dahua Motion Detection technology triggers alarm or records.

Day/Night

Dahua Day/Night function provides color image when illumination is adequate; when illumination is inadequate, it switches night mode and provides white and black image. It can guarantee that the network camera can work normally when illumination changes.

- 2-MP 1/2.8" CMOS image sensor, low luminance, and high definition image.
- Outputs max. 2 MP (1920 × 1080) @25/30 fps.
- H.265 codec, high compression rate, ultra-low bit rate.
- Built-in IR LED, and the max. illumination distance is 30 m.
- SMART H.264 +/H.265+, flexible coding, applicable to various bandwidth and storage environments.
- DWDR, 3D NR, BLC, digital watermarking, applicable to various monitoring scenes.
- Abnormality detection: Motion detection, video tampering, audio detection, no SD card, SD card full, SD card error, network disconnection, IP conflict, illegal access.
- Built-in dual-antenna 2.4G Wi-Fi that covers a range of up to 120 m in an open area.
- Supports max.256 G Micro SD card.Built-in MIC and speaker.
- 12 VDC power supply.
- IP67 protection.



Cyber Security

Dahua network cameras employ a series of security technologies, including security authentication and authorization, access control protocols, trusted protection, encrypted transmission and encrypted storage. These technologies improve the camera's defense against external cyber threats and prevent malicious programs from compromising the device.

Technical Specification

Camera

| | |
|----------------------------|---|
| Image Sensor | 1/2.8" CMOS |
| Max. Resolution | 1920 (H) × 1080 (V) |
| ROM | 16 MB |
| RAM | 64 MB |
| Scanning System | Progressive |
| Electronic Shutter Speed | Auto/Manual 1/3 s–1/100,000 s |
| Min. Illumination | 0.025 lux@F2.0 (Color, 30 IRE) 0.0025 lux@F2.0 (B/W, 30 IRE) 0 lux (Illuminator on) |
| S/N Ratio | > 56 dB |
| Illumination Distance | 30 m (98.43 ft) |
| Illuminator On/Off Control | Auto; Manual |
| Illuminator Number | 1 (IR LED) |

| | |
|-------------------------|---|
| Pan/Tilt/Rotation Range | Pan: 0°–360° Tilt: 0°–78° Rotation: 0°–360° |
|-------------------------|---|

Lens

| | | | | | |
|----------------------|---|--------------------|-------------------|-------------------|------------------|
| Lens Type | Fixed-focal | | | | |
| Lens Mount | M12 | | | | |
| Focal Length | 2.8 mm; 3.6 mm | | | | |
| Max. Aperture | F2.0 | | | | |
| Field of View | 2.8 mm: Horizontal: 100°; Vertical: 53°; Diagonal: 120° 3.6 mm: Horizontal: 86°; Vertical: 43°; Diagonal: 102° | | | | |
| Iris Control | Fixed | | | | |
| Close Focus Distance | 2.8 mm: 0.6 m (1.97 ft) 3.6 mm: 1.0 m (3.28 ft) | | | | |
| DORI Distance | Lens | Detect | Observe | Recognize | Identify |
| | 2.8 mm | 46.9 m (153.87 ft) | 18.8 m (61.68 ft) | 9.4 m (30.84 ft) | 4.7 m (15.42 ft) |
| | 3.6 mm | 58.8 m (192.91 ft) | 23.5 m (77.10 ft) | 11.8 m (38.71 ft) | 5.9 m (19.37 ft) |

Video

| | |
|--------------------|---|
| Video Compression | H.264B; H.264; H.264H; H.265 |
| Smart Codec | Smart H.265+; Smart H.264+ |
| Video Frame Rate | Main stream: 1920 × 1080 (1–25/30 fps) Sub stream: 640 × 480@(1–25 fps) 640 × 480@(1–30 fps) *The values above are the max. frame rates of each stream; for multiple streams, the values will be subjected to the total encoding capacity. |
| Stream Capability | 2 streams |
| Resolution | 1080p (1920 × 1080); 960p (1280 × 960); 720p (1280 × 720) |
| Bit Rate Control | CBR/VBR |
| Video Bit Rate | H264: 24 kbps–4096 kbps H265: 9 kbps–4096 kbps |
| Day/Night | Auto (ICR)/Color/B/W |
| BLC | Yes |
| WDR | DWDR |
| White Balance | Auto; natural; street lamp; outdoor; manual; regional custom |
| Gain Control | Auto |
| Noise Reduction | 3D NR |
| Motion Detection | OFF/ON (4 areas, rectangular) |
| Smart Illumination | Yes |
| Image Rotation | 0°/180° |
| Mirror | Yes |

Audio

| | |
|--------------|-----|
| Built-in MIC | Yes |
|--------------|-----|

| | |
|-------------------|-----------------|
| Built-in Speaker | Yes |
| Audio Compression | G.711a; G.711Mu |

Alarm

| | |
|-------------|--|
| Alarm Event | No SD card; SD card full; SD card error; network disconnection; IP conflict; illegal access; motion detection; video tampering; audio detection; intensity change; SMD (human) |
|-------------|--|

Network

| | |
|---------------------|--|
| Network Port | RJ-45 (10/100 Base-T) |
| Wi-Fi | IEEE802.11b/g/n 2.4–2.4835 GHz; 2.4 G |
| Wireless Range | Up to 120m(The performance varies based on actual environment) |
| SDK and API | Yes |
| Cyber Security | Video encryption; configuration encryption; Digest; WSSE; account lockout; security logs; generation and importing of X.509 certification; HTTPS; trusted boot; trusted execution; trusted upgrade |
| Network Protocol | IPv4; HTTP; TCP; UDP; ARP; RTP; RTSP; RTCP; DHCP; DNS; NTP; Multicast; RTMP |
| Interoperability | ONVIF (Profile S/Profile T); CGI; P2P |
| User/Host | 6 (Total bandwidth: 36 M) |
| Storage | Micro SD card (support max. 256 GB) |
| Browser | IE Chrome Firefox |
| Management Software | Smart PSS; DSS; DMSS |
| Mobile Client | iOS; Android |

Certification

| | |
|----------------|---|
| Certifications | CE-LVD: EN62368-1; CE-EMC: Electromagnetic Compatibility Directive 2014/30/EU; CE-RED: Radio Equipment Directive 2014/53/EU; FCC: 47 CFR FCC Part 15, Subpart B; FCC ID: FCC PART 15C |
|----------------|---|

Power

| | |
|-------------------|--|
| Power Supply | 12 VDC |
| Power Consumption | Basic: 1.9 W (12 VDC) Max. (H.265+IR intensity): 6.1 W (12 VDC) |

Environment

| | |
|-----------------------|--------------------------------------|
| Operating Temperature | –30 °C to +60 °C (–22 °F to +140 °F) |
| Operating Humidity | ≤ 95% |
| Storage Temperature | –30 °C to +60 °C (–22 °F to +140 °F) |
| Protection | IP67 |

Structure

| | |
|--------------------|---|
| Casing | Inner core: Metal + Plastic Cover: Plastic |
| Product Dimensions | ∅109.9 mm × 102.2 mm (∅4.33" × 4.02") |
| Net Weight | 352 g (0.77 lb) |
| Gross Weight | 530 g (1.17 lb) |

Ordering Information

| Type | Model | Description |
|-------------|-----------------------------|---|
| 2MP Camera | DH-IPC-HDW1230DTP-STW-0280B | 2 MP IR Fixed-focal WiFi Eyeball Network Camera, PAL, 2.8 mm |
| | DH-IPC-HDW1230DTN-STW-0280B | 2 MP IR Fixed-focal WiFi Eyeball Network Camera, NTSC, 2.8 mm |
| | DH-IPC-HDW1230DTP-STW-0360B | 2 MP IR Fixed-focal WiFi Eyeball Network Camera, PAL, 3.6 mm |
| | DH-IPC-HDW1230DTN-STW-0360B | 2 MP IR Fixed-focal WiFi Eyeball Network Camera, NTSC, 3.6 mm |
| Accessories | ADS-12AM-12 12012EPG | 12V DC/1A Power Adapter |
| | PFA13G | Junction Box |
| | PFB205W | Wall Mount |
| | PFA152-E | Pole Mount |
| | PFM900-E | Integrated Mount Tester |
| | TF-P100 | MicroSD Memory Card |
| | PFA109+PFB220C | Ceiling Mount |

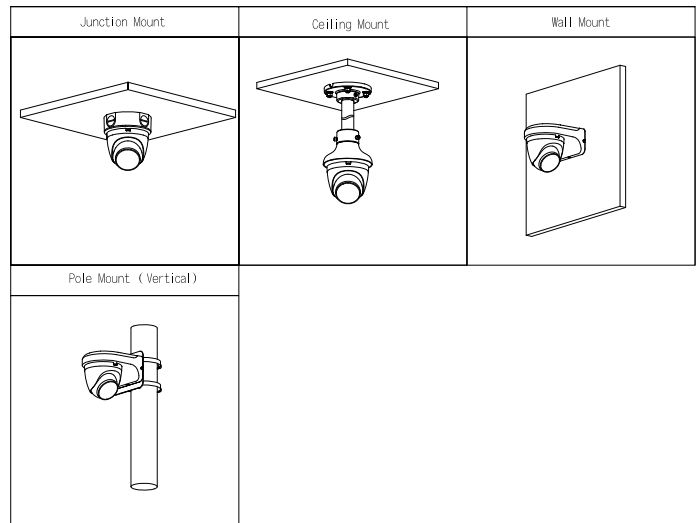

Dimensions (mm[inch])

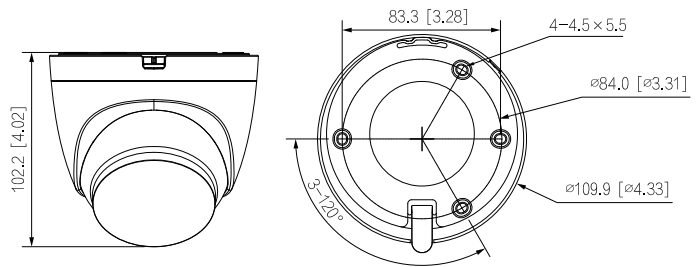

Accessories

Included:



ADS-12AM-12 12012EPG
12 V DC/1A
Power Adapter

Optional:



PFA13G
Junction Box



PFB205W
Wall Mount



PFA152-E
Pole Mount



PFM900-E
Integrated
Mount Tester



TF-P100
MicroSD
Memory Card



PFA109+PFB220C
Ceiling Mount