



## 5" and 7" In-Wall Touch Screen Wall Box Installation Guide

### New Construction



#### Supported Touch Screen Models

- C4-TSWMC5-EG-WH - 5" In-Wall Touch Screen, White
- C4-TSWMC5-EG-BL - 5" In-Wall Touch Screen, Black
- C4-TSWMC7-EG-WH - 7" In-Wall Touch Screen, White
- C4-TSWMC7-EG-BL - 7" In-Wall Touch Screen, Black

#### Supported Wall Box Models

Plastic Model  
(C4-NWB57C-P)

Metal Model  
(C4-NWB57C-M)

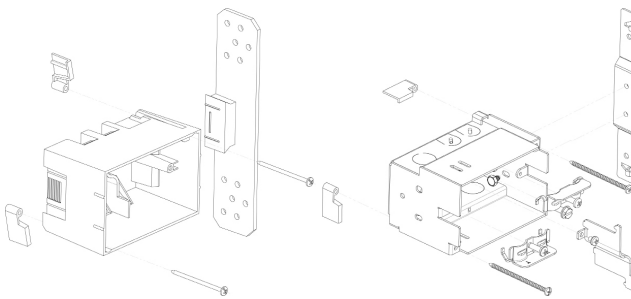

#### General Description

This Control4® kit provides a wall box to accommodate the installation of a 5" and 7" In-Wall Touch Screen. The kit is intended for new construction where drywall is not yet in place.

Along with the wall box, the kit contains a stud plate for attachment to a wall stud **prior to drywall installation**.



**Note:** If the drywall is in place, use one of the kits intended for retrofit (models C4-RWB57C-P or C4-RWB57C-M).

#### Requirements

- Tools to install the wall box, such as a tape measure, a pencil, a hammer or screwdriver (depending on whether you are using screws or nails), a drywall saw, a utility knife and other common drywall tools.
- A 5/16" nut driver or socket wrench, if using the metal wall box.
- Nails or screws (4 to 6).

#### What's in the Kit

- 5" and 7" In-Wall Touch Screen Wall Box for New Construction
- Two (2) ferrite clamps with a rectangular enclosure and one ferrite (1) clamp with a round enclosure
- *5" and 7" In-Wall Touch Screen Wall Box New Construction Installation Guide* (this document)

#### Specifications

##### Plastic Wall Box Model:

- 1 Stud plate
- 2 Wall box (New Construction)
- 3 Dovetail socket (on both sides to reverse position)

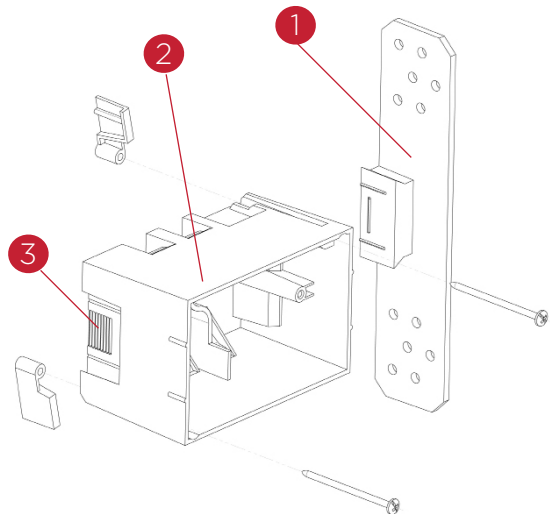

## 5" and 7" In-Wall Touch Screen Wall Box Installation Guide New Construction

### Metal Wall Box Model:

- 1 Mounting location (on both sides to reverse position)
- 2 Wall box (New Construction)
- 3 Stud plate

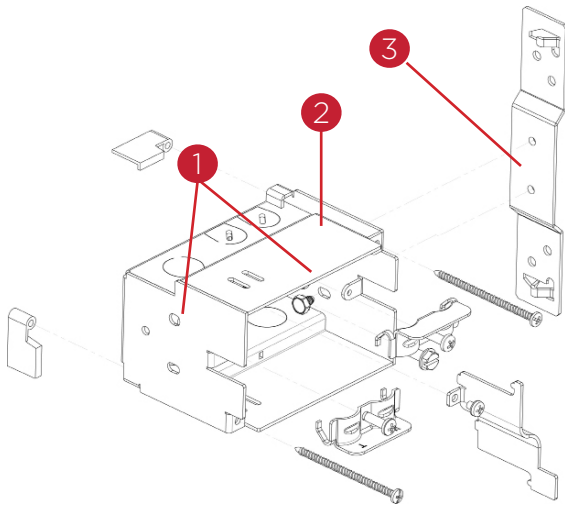

### Installation



**Note:** This kit is intended for installation of a wall box prior to drywall installation. If the drywall is already in place, use the retrofit installation kit (C4-RWB57C-P or C4-RWB57C-M).



**Notes:** (1) Install the wall box flush with the wall. (2) Wall box dimensions: (H x W x D): 2.7" x 4.1" x 2.4" (68mm x 104mm x 61mm).

- 1 Find an appropriate wall box location for the Touch Screen you are installing:
  - The wall box should be in a convenient location, for example, near the entrance of a room.
  - The wall box should be at eye level, approximately 57 to 61 inches from the floor.

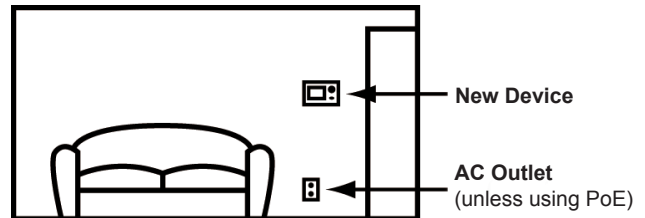

- When using the Ethernet models near a location where an Ethernet CAT5 cable is pulled.
- When using the wireless model above or near an AC power source, such as an AC outlet.

- 2 Hold the wall box and stud plate against the nearest stud, and mark the correct position according to your choices in Step 1. Follow these guidelines.

- a Place the wall box so that, when mounted, it will be flush with the surface of the drywall after the drywall is installed. For example, if the drywall is 3/8 of an inch deep, the front rim of the wall box must be 3/8 of an inch above the wall stud (toward you).



**IMPORTANT!** Make sure the wall box is flush with the wall after the drywall is installed. Allow 3/8 of an inch before the drywall is installed (depending on the thickness of the drywall), and err toward 5/16's of an inch for the best fit.

- b Install the wall box according to the arrows inside the box that indicate the correct side up.



**IMPORTANT!** For safety reasons, install the wall box with the correct side up so the Touch Screen interlocks with the wall box, allowing a barrier to separate high-voltage from low-voltage circuits.

- c Install the wall box with the stud plate on either the right or the left side, depending on which wall stud you choose. You may detach the stud plate from the wall box on one side and reattach it on the opposite side if needed.

- 3 Detach the stud plate from the wall box.

- **Plastic box:** Slide the wall plate toward the back of the wall box.
- **Metal box:** Inscrow the wall box from the stud plate.

This allows you to attach the stud plate to the wall stud without interference from the wall box.

- 4 Align the stud plate with the marks you made on the stud (Step 2). If you are using a plastic unit, make sure the dovetail is toward the back of the stud plate (away from you).
- 5 Nail or screw the stud plate to the wall stud.
- 6 Mount the wall box to the stud plate.
  - **Plastic box:** Slide the wall box onto the stud plate dovetail all the way, leaving the wall box protruding the depth of the drywall, or slightly less (Step 2a).
  - **Metal box:** bolt the wall box back onto the stud plate.



**Note:** If you are using a metal box, you can continue to adjust its angle and position slightly relative to the drywall.

- 7 Install the drywall according to the normal procedures, making sure to cut the size of the hole accurately.
- 8 After you install the drywall, carefully tighten the screws to pull in the securing tabs so that the wall box is flush with the surface of the wall.



**Note:** Overtightening the screws may pull the box into the wall.



**IMPORTANT!** When you are ready to install the drywall, and you are cutting the opening for the wall box, **DO NOT** cut the opening too large. Be conservative and enlarge the hole as needed, because there isn't as much overhang on the faceplate of the Touch Screen as you are accustomed to using with standard switch and outlet plates.

## Ferrite Clamp Installation

When installing the Control4® 5" or 7" In-Wall Touch Screen, also install the enclosed ferrite clamps (see next figure) as described in this document. The wall box packaging includes two (2) ferrite clamps with a

rectangular enclosure and one ferrite (1) clamp with a round enclosure.

### Ferrite Clamp Installation when Using Power over Ethernet (PoE)

When powering the 5" or 7" In-Wall Touch Screen using PoE, install the two (2) rectangular ferrite clamps on the Ethernet cable behind the wall box as shown next.

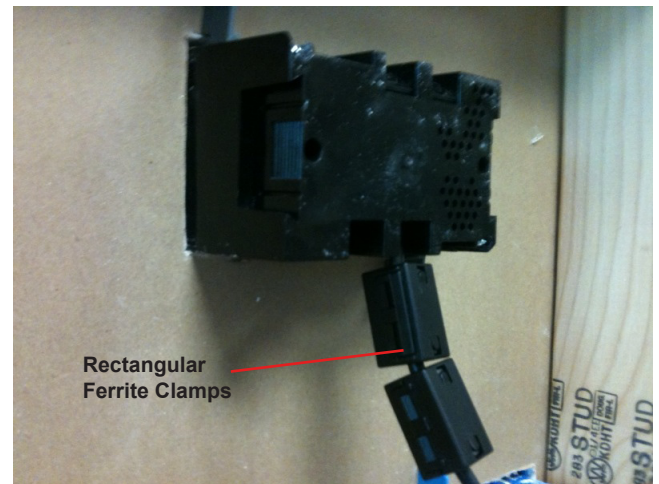

### Ferrite Clamp Installation when Using AC Power and a WiFi Network Connection

When powering the Touch Screen using 110 or 240 VAC, install the round ferrite clamp on the AC cable behind the wall box as shown below.



## Ferrite Clamp Installation when Using AC Power and an Ethernet Network Connection

When powering the Touch Screen using AC and connecting to the network using Ethernet, only install one (1) rectangular ferrite clamp on the Ethernet cable and one (1) round ferrite clamp on the AC cable behind the wall box as shown next.

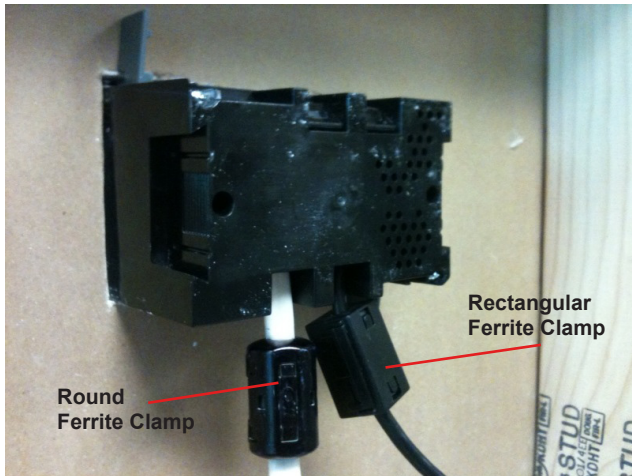

## Warranty

Limited 2-year Warranty. Go to <http://www.control4.com/warranty> for details.

## About This Document

Part number: 200-00165, Rev. E 7/06/2011