

# KIT PRODUCT TECHNICAL DATASHEET

# SET BR21/353

Brushless 

Intensive use 

Digital Encoder 



## Composition SET BR21/353

CODE	DESCRIPTION	QTY
<b>BR21/351</b>	Electromechanical underground motor, BRUSHLESS, low voltage, super intensive use, with native encoder onboard, irreversible, ideal for swing gates with leaf up to 4,5 m. Standard version with 2 m cable.	2
<b>FU100</b>	Cold galvanised foudation box and lid.	2
<b>RL650</b>	Release system with standard lever.	2
<b>KIT EDGE1/20</b>	Electronic kit with digital controller 36V EDGE1/BOX for 2 motors BRUSHLESS.	1
	<b>Composition KIT EDGE1/20</b>	
	<b>EDGE1/BOX</b> Digital control 36V for 2 BRUSHLESS motor, with plastic box.	1
	<b>H93/RX22A/I</b> Plug-in receiver 2 channels 433,92 Mhz (500 storable codes) for control unit series H70, B70, EDGE and CTRL.	1
	<b>SYNUS/2</b> Dual code transmitter (modality fixed code or rolling code), 433,92 Mhz. 2 channels, with radio for copy.	2
	<b>R90/F4ES</b> Pair of external photocells synchronized 24V AC/DC (max. 4 pairs).	1
	<b>FIFTHY/24</b> LED flashing light series FIFTHY 24V with integrated antenna.	1
	<b>R99/C/001</b> Signboard "Automatic Opening".	1

## PRODUCT TECHNICAL SPECIFICATIONS

Power line supply	230V AC - 50 Hz
Motor power supply	24V - 36V
Power rating	200W
Frequency of use	Intensive use
Torque	50 - 300N m
Operating temperature	-20+55°C

Protection level	IP67
Reductor Type	Irreversible
Manoeuvre speed	1,2 Rpm
Opening time	19-29 s
Limit switch	Mechanical stoppers
Recommended digital controllers	-
Encoder	Digital native encoder SENSORLESS 48 PPR
Maximum opening	105° (optional 125° - 360°)
Power supply cable length	2m
Bearing on main shaft	Standard
Operating cycles per day (opening/closing - 24 hours no stop)	1300
Maximum dimension product in mm (L x W x H)	345 x 224 x 144
Product weight packed (Kg)	68,6

# PRODUCT DIMENSIONS AND PREPARING FOR INSTALLATION

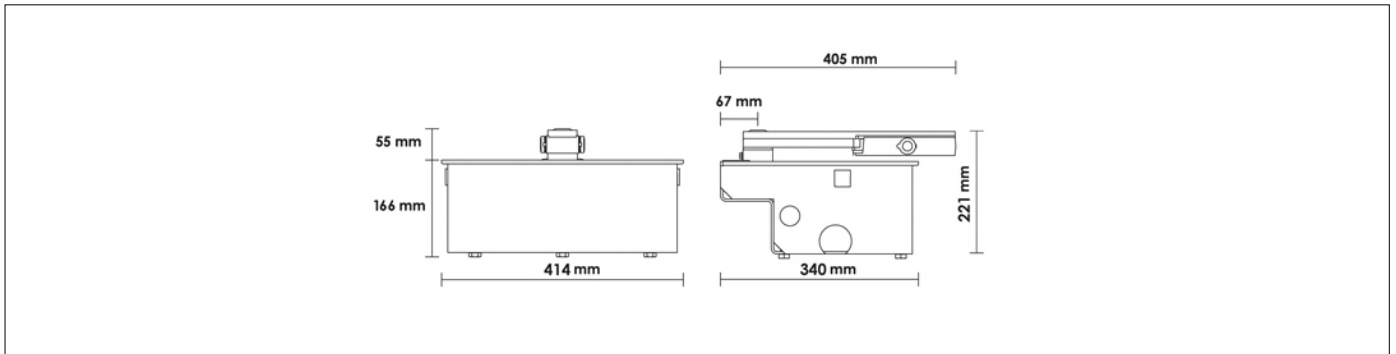

DIMENSIONS

## PRODUCT PREPARING FOR INSTALLATION

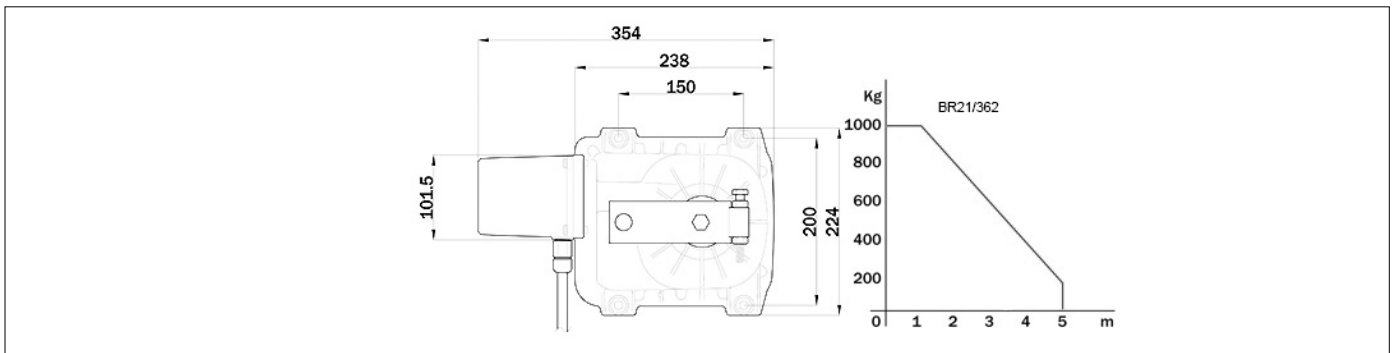

PREDISPOSITION FOR STANDARD INSTALLATION

## PRODUCT ACCESSORIES

<p><b>B71/PBX36/BOX</b> Hybrid inverter, "Network Assisted" version, for powering the automation. Also provides a battery-charger function thanks to the connection to the solar panels or mains supply for powering the 36V DC brushless digital controllers with a mains voltage of 230V AC.</p>	<p><b>B71/PBX36/BOX/115</b> Hybrid inverter, "Network Assisted" version, for powering the automation. Also provides a battery-charger function thanks to the connection to the solar panels or mains supply for powering the 36V DC brushless digital controllers with a mains voltage of 115V AC.</p>	<p><b>B71/PBX/BOX</b> Hybrid inverter, "Full Solar" version, for powering the automation. Also provides a battery-charger function thanks to the connection to the solar panels for powering the brushless digital controllers.</p>	<p><b>LT300</b> Levers for opening up to 125°.</p>	<p><b>LT301</b> Levers for opening up to 360°.</p>	<p><b>LT301/R</b> Levers for opening up to 360°, with reinforced chain.</p>
<p><b>LT300/90SX</b> Levers for opening up to 103° - 90° turned - left.</p>	<p><b>LT300/90DX</b> Levers for opening up to 103° - 90° turned - right.</p>	<p><b>LT327/SC</b> Pinion gear <math>\frac{3}{4}</math> Z13 of adaptation in pinion combining <math>\frac{3}{4}</math> Z16.</p>	<p><b>RL650/R</b> Release system with standard lever, reinforced steel version.</p>	<p><b>RL651</b> Release system with european cylinder key.</p>	<p><b>RL663</b> Long release lever for underground.</p>